

# TC12-125-FG

(12V125Ah/10hr)



GEL Series is GEL battery which is manufactured with AGM separator and colloidal Silicon. Gel battery are featured with low self-discharge、strong ability to recover from deep discharging、excellent cycle life and performance at cold ambient temperatures than conventional VRLA

## Battery Construction

Component	Positive plate	Negative plate	Container	Cover	Safety valve	Terminal	Separator	Electrolyte
Raw material	Lead dioxide	Lead	ABS	ABS	Rubber	Copper	Fiberglass	Colloidal silicon

## General Feature

- Micro millimeter SiO<sub>2</sub> and H<sub>2</sub>SO<sub>4</sub> technology for Efficient gas recombination of up to 99% and Freedom from electrolyte maintenance or water adding.
- Not restricted for air transport-complies with IATA/ICAO Special Provision A67.
- UL-recognized component.
- Can be mounted in any orientation.
- Computer designed lead, calcium tin alloy grid for high power density.
- Long service life, float or cyclic applications.
- Maintenance-free operation.
- Low self discharge.

## Performance Characteristics

Capacity 77°F(25°C)	20 hour rate (6.6A、10.5V)	132Ah
	10 hour rate (12.5A、10.5V)	125Ah
	5 hour rate (22.6A、10.5V)	113Ah
	1 hour rate (83A、9.6V)	83Ah
Internal Resistance	Full charged Battery77°F(25°C): 5mΩ	
Capacity affected by Temperature (10 hour rate)	104° F(40°C)	102%
	77° F(25°C)	100%
	32° F(10°C)	85%
	5° F(-15°C)	65%
Self-Discharge 68°F(20°C)	Capacity after 3 month storage	90%
	Capacity after 6 month storage	80%
	Capacity after 12month storage	60%
Max. discharge current77°F(25°C): 900A(5S)		
Charge (Constant Voltage)	Float: 13.6~13.8 V/77° F/(25°C)	
	Cycle:14.5~14.9 V/77°F(25°C) Max. Current: 31.3A	

## SPECIFICATION

Nominal voltage	.....	12V
Number of cell	.....	6
Length(mm/inch)	.....	436/17.2
Width(mm/inch)	.....	108/4.25
Height(mm/inch)	.....	317/12.5
Total Height(mm/inch)	.....	317/12.5
Approx. Weight(kg/lbs)	.....	37.5 Kg

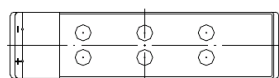
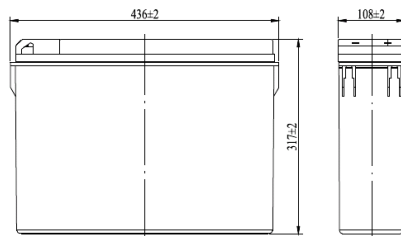

Terminal(M8-18.8)

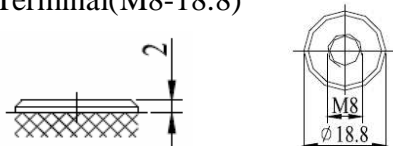

Discharge Constant Current (Amperes at 77° F25 °C)

End Point Volts/Cell	10min	15min	30min	45min	1h	3h	5h	10h	20h
1.60V	265	208	135	102	83.0	34.5	23.2	12.8	6.75
1.65V	245	198	132	100	81.8	34.3	23.0	12.7	6.70
1.70V	225	187	129	98.0	80.6	34.0	22.8	12.6	6.65
1.75V	205	176	126	96.0	79.4	33.7	22.6	12.5	6.60
1.80V	183	163	122	93.0	78.1	33.3	22.3	12.4	6.50

Discharge Constant Power (watts at 77° F 25 °C)

End Point Volts/Cell	10min	15min	30min	45min	1h	2h	3h	5h	
1.60V		450	376	252	192	157	90.8	66.1	44.2
1.65V		428	361	246	188	154	89.3	65.4	43.9
1.70V		406	347	239	184	150	87.9	64.7	43.6
1.75V		383	333	232	179	147	86.4	63.9	43.2
1.80V		361	318	225	175	144	85.0	63.2	42.9

(Note)The above characteristics data are average values obtained Within three charge/discharge cycles not the minimum values.

